

## Product Information

Capstan grips Types 8314, Fmax 10 kN and 8315, Fmax 20 kN, mechanical

CTA: 40178 40179

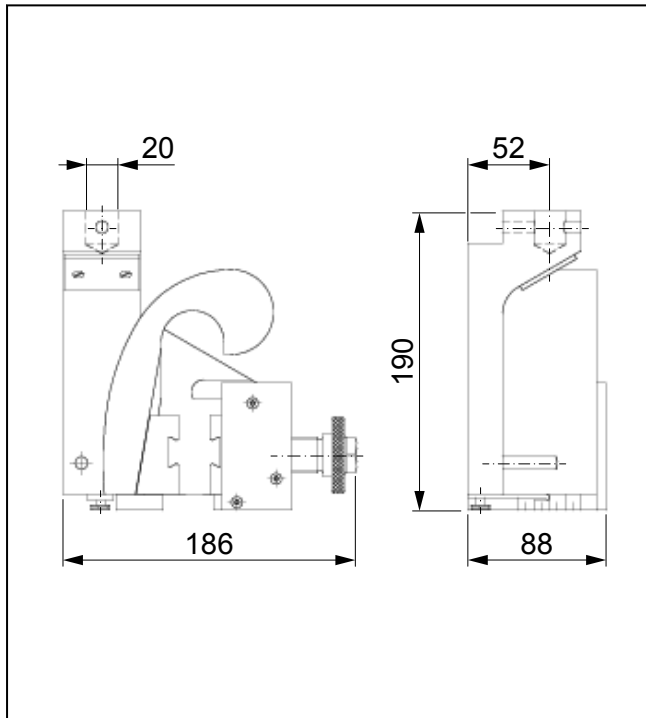

Capstan grips type 8314 Fmax 10 kN, mechanical

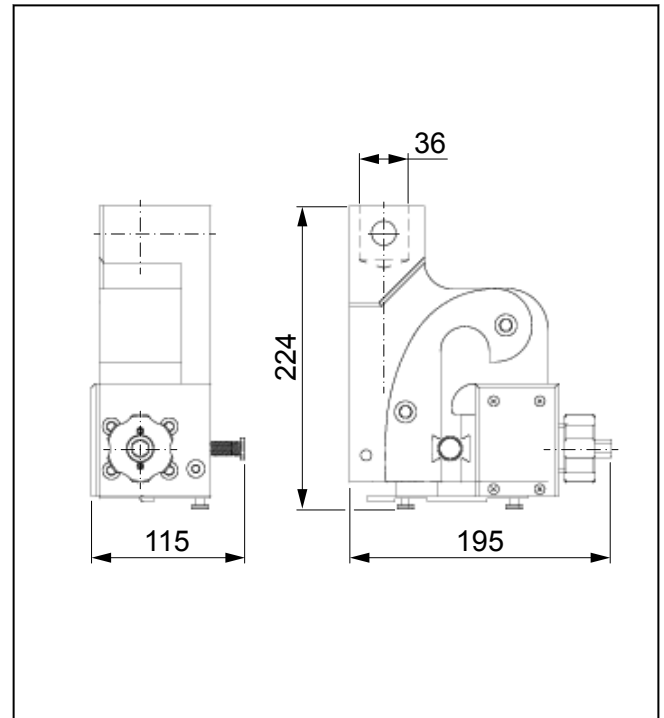

Capstan grips type 8314 Fmax 20 kN, mechanical

### Applications

- Specimen material:  
plastics, textiles
- Specimen shape:  
tape, yarn
- Type of loading:  
tensile

### Function description

These capstan grips for yarn and tire cord are single-actuator grips for clamping fibrous or filamentary tensile specimens.

The load-reduction curve with 360° deflection gently reduces the tensile force before the clamping point. Mechanical clamping via screw drive holds the specimen securely, avoiding jaw breaks.

With Type 8314 capstan grips the gripping force is generated via wedge action.

The Type 8315 capstan grips possess a mechanical advantage element whereby the gripping force is generated by tightening at a low torque.

### Advantages and features

- Secure holding of the specimen ensures reliable test results, even with specimens prone to shrinkage.
- High specimen throughput thanks to quick specimen insertion and centering via guide groove.
- The load-reduction curve ensures gentle gripping with no jaw breaks.
- The jaws can be changed quickly and easily for different applications - no tools required. The jaws are centered automatically.

## Product Information

Capstan grips Types 8314, F<sub>max</sub> 10 kN and 8315, F<sub>max</sub> 20 kN, mechanical

### Technical data

Type Item No.	8314 313518	8315 318670	
Operating principle/feature	mechanical screw end-clamping	mechanical screw end-clamping	
Test load F <sub>max</sub>	10	20	kN
Max. closing force at 35 Nm tightening torque	dep. on tensile force	40	kN
Dimensions			
Height	190	224	mm
Width	186	195	mm
Depth	88	115	mm
Clamping travel	10	1.2	mm
Opening width, max.	10	10	mm
Clamping range with central gripping	6	5	mm
Specimen thickness/diameter	0.2 to 6	0.2 to 5	mm
Specimen width, max.	60	60	mm
Connection, stud	Ø 20	Ø 36	mm
Weight per grip unit, approx.	6.7	11	kg
Ambient temperature	-40 to +250	-40 to +250	°C
Scope of delivery	2	2	pieces

### Accessories required

#### Jaws (1x required)

Type 8487